



**THE RITZ - CARLTON
RESIDENCES**

NAPLES

PARK RESIDENCES



PARK RESIDENCES

The Park Residences represents the final residential offering at The Ritz-Carlton Residences, Naples. This elegant mid-rise building features five floors of residences over one level of parking, with just 20 exclusive three-bedroom residences starting from over 2,600 square feet.

Strategically positioned adjacent to The Park at The Ritz-Carlton Residences, Naples—a lush half-acre of meticulously landscaped green spaces—this final building offers residents an unparalleled connection to nature and tranquility within this prestigious community.



**THE PARK AT
THE RITZ-CARLTON RESIDENCES, NAPLES**

Tucked discreetly away, The Park at The Ritz-Carlton Residences, Naples, unfolds as a serene retreat along the property's expanse. Manicured lawns, stately palms, water features, and shaded pavilions create an idyllic setting. This hidden gem features a putting green, bocce ball, fire pits, and outdoor seating, all embraced by the refreshing Gulf Coast breezes.





UNPARALLELED AMENITIES & SERVICES

Owners of The Park Residences will enjoy their own rooftop pool, as well as all the amenities of the 28,000-square-foot Vanderbilt Club, with its private full-service spa, on-site restaurant, full-service marina, resort-style pools featuring cabana suites and fire pits, an expansive fitness center, plush theater, brilliantly crafted spaces for kids and teens, and endless other delights.

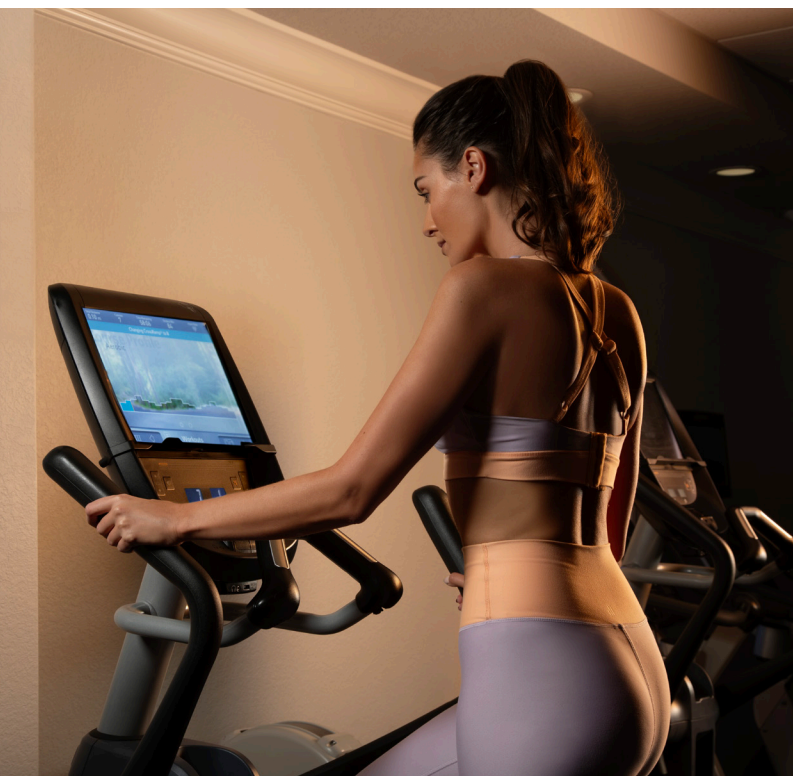

PARK RESIDENCE 01 LEVEL 02

3 Bedrooms • 3.5 Baths • 9-foot Ceilings
 Owner's Suite with His and Her Wardrobe
 Great Room • Foyer • Expansive Terraces

Living Area	2,691 sq.ft.
Terraces	1,132 sq.ft.
Total Residence	3,823 sq.ft.

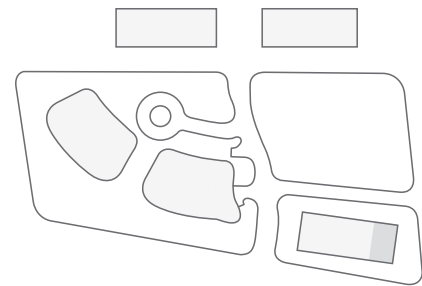
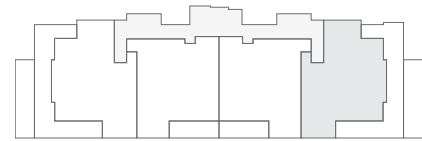

THE RITZ CARLTON RESIDENCES, NAPLES ARE NOT OWNED, DEVELOPED OR SOLD BY THE RITZ CARLTON HOTEL COMPANY, L.L.C. OR ITS AFFILIATES ("RITZ CARLTON"). STOCK RESIDENCES USES THE RITZ CARLTON MARKS UNDER LICENSE FROM THE RITZ CARLTON HOTEL COMPANY, L.L.C. WHICH HAS NOT CONFIRMED THE ACCURACY OF ANY OF THE STATEMENTS OR REPRESENTATIONS MADE HEREIN.



PARK RESIDENCE 01 LEVELS 03-06

3 Bedrooms • 3.5 Baths • 9-foot Ceilings
 Owner's Suite with His and Her Wardrobe
 Great Room • Foyer • Expansive Terraces

Living Area	2,691 sq.ft.
Terraces	385 sq.ft.
Total Residence	3,076 sq.ft.

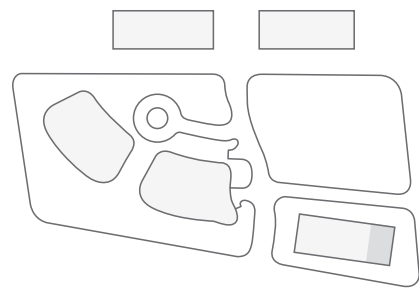
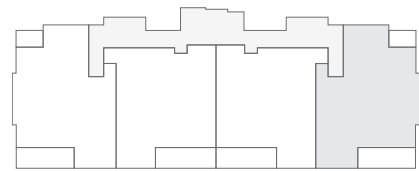

THE RITZ CARLTON RESIDENCES, NAPLES ARE NOT OWNED, DEVELOPED OR SOLD BY THE RITZ CARLTON HOTEL COMPANY, L.L.C. OR ITS AFFILIATES ("RITZ CARLTON"). STOCK RESIDENCES USES THE RITZ CARLTON MARKS UNDER LICENSE FROM THE RITZ CARLTON HOTEL COMPANY, L.L.C. WHICH HAS NOT CONFIRMED THE ACCURACY OF ANY OF THE STATEMENTS OR REPRESENTATIONS MADE HEREIN.

PARK RESIDENCE 02 LEVELS 02-06

3 Bedrooms • 3.5 Baths • 9-foot Ceilings
 Owner's Suite with His and Her Wardrobe
 Great Room • Foyer • Expansive Terrace

Living Area	2,574 sq.ft.
Terrace	288 sq.ft.
Total Residence	2,862 sq.ft.

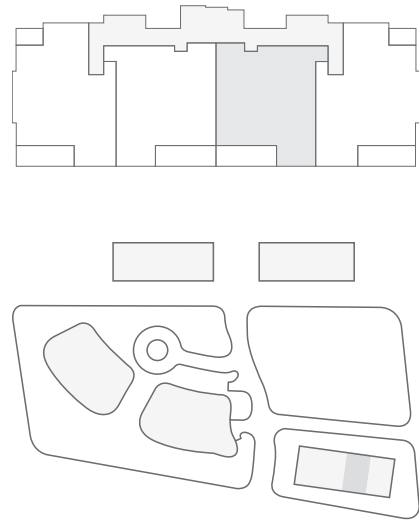

THE RITZ CARLTON RESIDENCES, NAPLES ARE NOT OWNED, DEVELOPED OR SOLD BY THE RITZ CARLTON HOTEL COMPANY, L.L.C. OR ITS AFFILIATES ("RITZ CARLTON"). STOCK RESIDENCES USES THE RITZ CARLTON MARKS UNDER LICENSE FROM THE RITZ CARLTON HOTEL COMPANY, L.L.C. WHICH HAS NOT CONFIRMED THE ACCURACY OF ANY OF THE STATEMENTS OR REPRESENTATIONS MADE HEREIN.

PARK RESIDENCE 03 LEVELS 02-06

3 Bedrooms • 3.5 Baths • 9-foot Ceilings
 Owner's Suite with His and Her Wardrobe
 Great Room • Foyer • Expansive Terrace

Living Area	2,574 sq.ft.
Terrace	288 sq.ft.
Total Residence	2,862 sq.ft.

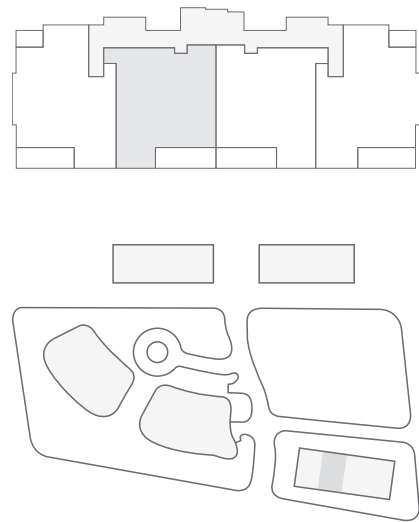

THE RITZ CARLTON RESIDENCES, NAPLES ARE NOT OWNED, DEVELOPED OR SOLD BY THE RITZ CARLTON HOTEL COMPANY, L.L.C. OR ITS AFFILIATES ("RITZ CARLTON"). STOCK RESIDENCES USES THE RITZ CARLTON MARKS UNDER LICENSE FROM THE RITZ CARLTON HOTEL COMPANY, L.L.C. WHICH HAS NOT CONFIRMED THE ACCURACY OF ANY OF THE STATEMENTS OR REPRESENTATIONS MADE HEREIN.

PARK RESIDENCE 04 LEVEL 02

3 Bedrooms • 3.5 Baths • 9-foot Ceilings
 Owner's Suite with His and Her Wardrobe
 Great Room • Foyer • Expansive Terraces

Living Area	2,691 sq.ft.
Terraces	1,147 sq.ft.
Total Residence	3,838 sq.ft.

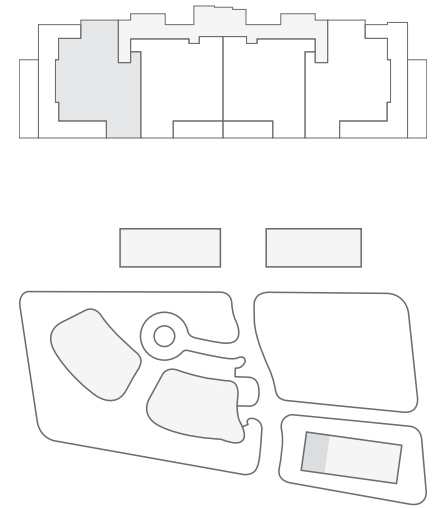

THE RITZ CARLTON RESIDENCES, NAPLES ARE NOT OWNED, DEVELOPED OR SOLD BY THE RITZ CARLTON HOTEL COMPANY, L.L.C. OR ITS AFFILIATES ("RITZ CARLTON"). STOCK RESIDENCES USES THE RITZ CARLTON MARKS UNDER LICENSE FROM THE RITZ CARLTON HOTEL COMPANY, L.L.C. WHICH HAS NOT CONFIRMED THE ACCURACY OF ANY OF THE STATEMENTS OR REPRESENTATIONS MADE HEREIN.

PARK RESIDENCE 04 LEVELS 03-06

3 Bedrooms • 3.5 Baths • 9-foot Ceilings
 Owner's Suite with His and Her Wardrobe
 Great Room • Foyer • Expansive Terraces

Living Area	2,691 sq.ft.
Terraces	385 sq.ft.
Total Residence	3,076 sq.ft.

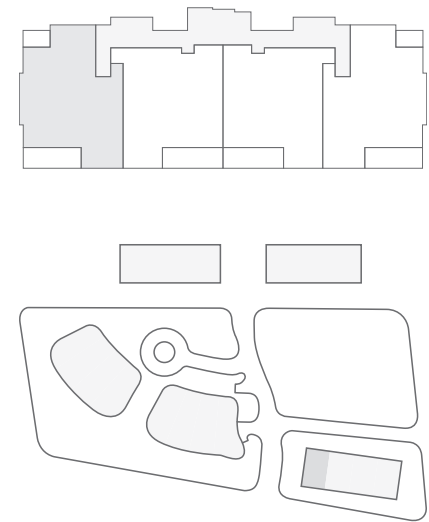

THE RITZ CARLTON RESIDENCES, NAPLES ARE NOT OWNED, DEVELOPED OR SOLD BY THE RITZ CARLTON HOTEL COMPANY, L.L.C. OR ITS AFFILIATES ("RITZ CARLTON"). STOCK RESIDENCES USES THE RITZ CARLTON MARKS UNDER LICENSE FROM THE RITZ CARLTON HOTEL COMPANY, L.L.C. WHICH HAS NOT CONFIRMED THE ACCURACY OF ANY OF THE STATEMENTS OR REPRESENTATIONS MADE HEREIN.



THE RITZ-CARLTON RESIDENCES

NAPLES

Call or visit the Sales Gallery today.

2355 Vanderbilt Beach Road, Suite 106, Naples, FL 34109 | T: 239.249.6260 | RCRNaples.com



THE RITZ-CARLTON RESIDENCES, NAPLES ARE NOT OWNED, DEVELOPED OR SOLD BY THE RITZ-CARLTON HOTEL COMPANY, L.L.C. OR ITS AFFILIATES ("RITZ-CARLTON"). STOCK RESIDENCES USES THE RITZ-CARLTON MARKS UNDER LICENSE FROM THE RITZ-CARLTON HOTEL COMPANY, L.L.C. WHICH HAS NOT CONFIRMED THE ACCURACY OF ANY OF THE STATEMENTS OR REPRESENTATIONS MADE HEREIN. THE AMENITY EXPERIENCE DESCRIBED IN THIS BROCHURE IS CONCEPTUAL AND CERTAIN ELEMENTS AND FEATURES MAY BE SUBJECT TO CHANGE. THE DEVELOPER DOES NOT GUARANTEE DELIVERY OF ANY FEATURE BEYOND THOSE CONFIRMED VIA WRITTEN CONTRACT AND/OR CLOSING DOCUMENTS.

ORAL REPRESENTATIONS CANNOT BE RELIED UPON AS CORRECTLY STATING THE REPRESENTATIONS OF THE DEVELOPER. FOR CORRECT REPRESENTATIONS REFERENCE SHOULD BE MADE TO THE DOCUMENTS REQUIRED BY SECTION 718.503, FLORIDA STATUTES, TO BE FURNISHED BY A DEVELOPER TO A BUYER OR LESSEE. STATED LIVING AREA IS MEASURED TO THE EXTERIOR FACE OF EXTERIOR WALLS, WITHOUT EXCLUDING AREAS THAT MAY BE OCCUPIED BY COLUMNS OR OTHER STRUCTURAL COMPONENTS. THIS METHOD OF MEASUREMENT VARIES FROM, AND IS LARGER THAN, THE DIMENSIONS THAT WOULD BE DETERMINED BY USING THE DESCRIPTION AND THE DEFINITION OF THE UNIT SET FORTH IN THE DECLARATION (WHICH GENERALLY ONLY INCLUDES THE INTERIOR AIRSPACE BETWEEN THE PERIMETER WALLS AND EXCLUDES STRUCTURAL COMPONENTS). ALL DIMENSIONS ARE APPROXIMATE AND MAY VARY WITH ACTUAL CONSTRUCTION. MEASUREMENTS OF ROOMS/TERRACES SET FORTH ON THIS FLOOR PLAN ARE TAKEN AT THE GREATEST POINTS OF EACH ROOM/TERRACE (AS IF THE ROOM WERE A PERFECT RECTANGLE), WITHOUT REGARD FOR ANY CUTOUTS OR IRREGULARITIES. ACCORDINGLY, THE AREA OF THE ACTUAL ROOM WILL TYPICALLY BE SMALLER THAN THE PRODUCT OBTAINED BY MULTIPLYING THE STATED LENGTH TIMES WIDTH. ALL FLOOR PLANS AND DEVELOPMENT PLANS ARE SUBJECT TO CHANGE. THE DEVELOPER EXPRESSLY RESERVES THE RIGHT TO MAKE MODIFICATIONS, REVISIONS, AND CHANGES WITHOUT NOTICE. ALL DEPICTIONS OF FURNISHINGS, APPLIANCES, BUILT-INS, COUNTERS, SOFFITS, FLOOR COVERINGS, LIGHTING, LANDSCAPING AND OTHER MATTERS OF DETAIL, INCLUDING, WITHOUT LIMITATION, ITEMS OF FINISH AND DECORATION, ARE CONCEPTUAL ONLY AND ARE NOT NECESSARILY INCLUDED IN EACH UNIT. CONSULT YOUR PROSPECTUS AND PURCHASE AGREEMENT.

